



THE DOCK

7 HANOVER QUAY, DUBLIN 2

MCA ARCHITECTS

PROFESSIONAL TEAM

Rogerson Reddan & Associates

JV Tierney & Company

Barrett Mahony

FCC Fire Cert Ltd

AWN Consulting

A showcase for Accenture clients and a workplace of the future, this building is a global HQ for Accenture's innovation and R&D activities.

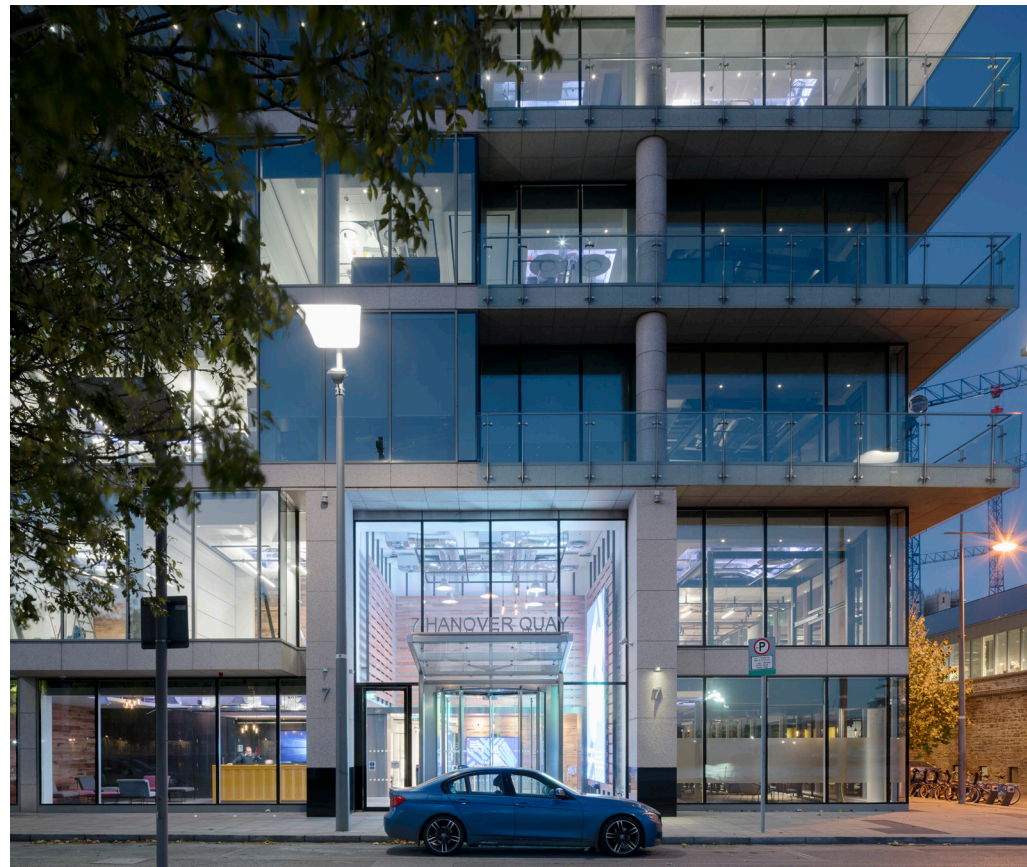

CLIENT'S VISION

The client brief was to create no less than the workplace of the future; a global HQ for Accenture's innovation and R&D activities which would include a highly flexible workspace to accommodate a workforce of software developers, IoT, artificial intelligence and robotics experts as well as being a showcase for Accenture clients.

UNIQUE CHALLENGES

The functional brief was challenging as the building itself needed to be a powerful employee and client experience i.e. clients would be brought in to see how innovation was taking place as well as having the ability to cater for clients' privacy and workshop areas. In parallel, the building would serve as an executive suite for the company's directors and their recurring gatherings.

SOLVING THE CHALLENGES WITH DESIGN

Together with Accenture's stakeholder group and the design team, MCA

developed innovative solutions for design, functionality and services enveloped in a look and feel that captures the spirit of the Docklands, using reclaimed timbers, container-like structures and shopfloor colour coding.

HOW CHALLENGES BECAME INNOVATIONS

Highly flexible work floors were achieved by deploying a custom made ceiling-mounted rafts with pull-down power and data "Ninjas" which releases the floor plate to movable desking on casters. State of the art "Skyfold" automatic walls enhances synergies between the larger meeting spaces. Large LED walls were installed in the reception, in the town hall and in the lift lobbies where employees can generate content via custom built apps. More than 10,000 sensors are distributed throughout the building connecting to a state of the art platform accessible by all employees which enables them to monitor and control their environment.

Client	Accenture
Value	€13.9M
Start Date	2015
Finish Date	2016
Size	74,800ft ² / 6,950m ²

THE DOCK
7 HANOVER QUAY, DUBLIN 2

